

Extensions for replace nozzles

extension BRASS for replace nozzles



code key: 300-VERxx

length of extension

20 = 20mm

25 = 25mm

30 = 30mm

40 = 40mm

50 = 50mm

55 = 55mm

extension ALUMINIUM for tube-in-tube system

extension ALUMINIUM complete with counter nut and spray medium hose



code key: 300-VERxxxAL/K

length of extension

050 = 50mm

100 = 100mm

150 = 150mm

200 = 200mm

length of spray medium hose

= 78mm

= 128mm

= 178mm

= 228mm

spare parts



extension ALUMINIUM
 order number: 300-VERxxxAL



counter nut
 order number: 304-D6830/3



spray medium hose
 order number: 300-VERxxxAL/1

adapter for cap holders

adapter complete with counter nut and spray medium hose



order number: 300-D6830/K

spare parts

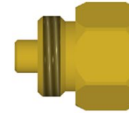

adapter

order number: 300-D6830



counter nut

order number: 304-D6830/3



spray medium hose

order number: 300-D6830/1

assembly example 300-VER50

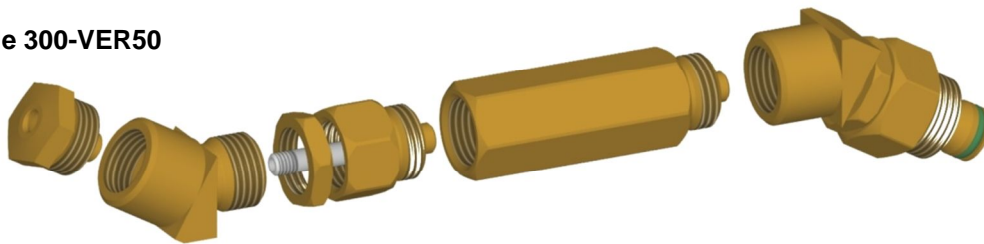

replace nozzle

300-56000

300-D6830/K

300-VER50

304-D5830/K30

304-D6830/K30

assembly example 300-VER100AL/K

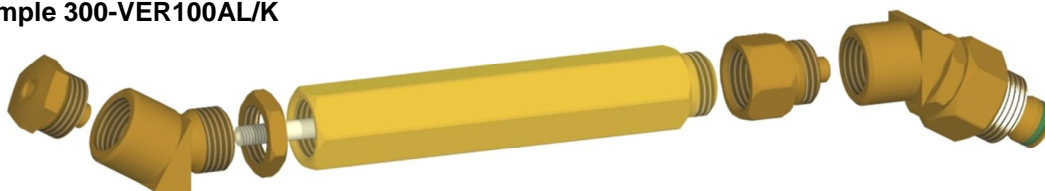

replace nozzle

300-56000

300-VER100AL/K

300-D6830

304-D5830/K30

304-D6830/K30